



COMMONWEALTH OF PENNSYLVANIA  
**PENNSYLVANIA GAME COMMISSION**

FIELD REGIONS  
253 Snyder Road  
Reading, PA 19605  
July 19, 2019

REQUEST FOR BIDS  
ROAD CONSTRUCTION  
STATE GAME LAND # 080  
SCHUYLKILL COUNTY

Prospective Service Contractors:

The Southeast Region of the Pennsylvania Game Commission is soliciting bids for the construction of 4,589 feet of woods road on State Game Land No. 080, Pine Grove Township, Schuylkill County. The location of the project is defined on the attached map. Specifications are detailed in Attachment 1 of the bid packet.

Bids are to be submitted electronically thru the Commonwealth's "PA Supplier Portal" system **by 2 PM August 14, 2019**. If you have not registered as a vendor with the state, you must do this first at [www.pasupplierportal.state.pa.us](http://www.pasupplierportal.state.pa.us) before submitting an electronic bid. Any questions regarding this may be directed to Michelle Briel at 610-926-3136 x 6020 [mbriel@pa.gov](mailto:mbriel@pa.gov).

**Service bid should be by a Unit Price (feet) as well as the total bid price for the project.**

Payment will be dispersed based on the number of whole feet completed to the required as per the required specifications.

**The work may begin on after October 1, 2019 provided all other contract items are provided and the work must be completed by November 22, 2019.**

The PGC will provide an optional one time tour of the site on Tuesday August 6, 2019 at 9 AM.

The attached Bid Prospectus provides all necessary specifications, instructions, contact information, map, etc.

Please contact me if you have any questions.

Randall Bauman  
Regional Forester  
Office: 610-926-3136 X 6686  
Cell Phone 717-413-1362  
Email: [rbauman@pa.gov](mailto:rbauman@pa.gov)

## GENERAL SPECIFICATIONS

### I. SCOPE OF WORK:

The Pennsylvania Game Commission, Southeast Region, requires woods road construction services. Services shall include, but not be limited to, the furnishing of all labor, superintendence, tools and equipment for the construction of 4,589 feet of woods road. Detailed specification can be found in the attached bidding specifications. ***All Purchase Orders require the contractor to provide the equipment, labor, insurance, and all miscellaneous expenses to complete the operation.***

Any questions concerning the technical aspects of this bid should be directed to the Regional Forester:

Randall Bauman  
PGC, Southeast Region  
253 Snyder Road  
Reading PA 19605-9254  
Phone: 717-413-1362

### II. CONTRACT TASKS:

#### A. Project Location:

The road construction will occur on State Game Lands No. 080, Pine Grove Township, Schuylkill County.

B. Contractor shall comply with Attachment 1, Road Construction Specifications.

### III. SITE INSPECTION AND ASSISTANCE:

The PGC will conduct an optional one-time-only tour of the site for prospective bidders on Tuesday August 6, 2019 at 9 AM. The tour will meet at the PGC access road along Swopes Valley Road as shown on the attached map.

### IV. CONTRACT REQUIREMENTS:

A. Work on the road must be completed by the termination date: **November 22, 2019.**  
No contract extension will be approved.

B. The contractor agrees to comply with this attachment.

C. A performance bond of \$3,000.00 is due by September 3, 2019 or before work begins, whichever comes first.

D. Failure to comply with any of the terms or conditions of the Contract may result in cancellation of the agreement.

E. All trees in the road corridor must be felled and all sawtimber logs in the road corridor must be removed from site. Sawtimber logs are defined as logs over 10 inches diameter at the small end. Work may not begin until October 1, 2019 due Indiana Bat restrictions. A stand and stock table of trees in the road corridor is attached.

### V. INSURANCE REQUIREMENTS:

- A. The contractor will provide Workmen's Compensation insurance sufficient to cover all of the employees of contractor working to fulfill this contract.
- B. Comprehensive General Liability Insurance, including bodily injury and property damage insurance, to protect the Commonwealth and the contractor from claims arising out of the performance of the contract. The amount of Bodily Injury Insurance shall not be less than \$300,000.00 for injury to or death of persons per occurrence. The amount of Property Damage Insurance shall not be less than \$300,000.00 per occurrence.

**Such policies shall name the Commonwealth as an additional insured.** Prior to the commencement of work under this contract, the contractor must provide the Commonwealth with current Certificates of Insurance. These Certificates shall contain a provision that coverage afforded under the policy shall not be canceled or changed until at least thirty (30) days prior written notice has been given to the Commonwealth.

**HOLD HARMLESS:**

The contractor shall be responsible for and agrees to indemnify and hold harmless the Commonwealth from and against damages to property or injuries (including death) to any persons and other losses, damages, expenses, claims, demands, suits, and actions by any party against the Commonwealth in connection with the work performed by the contractor.

**VI. BID AWARD:**

**Service quote on the construction and improvement of woods road should include the Unit Price (\$/foot) as well as total for the project feet.** Payment will be by Unit (acre) completed to the specifications of Attachment 1.

**Bid will be awarded to the lowest total amount.**

Bids are to be submitted electronically thru the Commonwealth's "PA Supplier Portal" system by **2:00 PM, Tuesday August 14, 2019.** If you have not registered as a vendor with the state, you must do this at [www.pasupplierportal.state.pa.us](http://www.pasupplierportal.state.pa.us) prior to submitting an electronic bid. The Commission reserves the right to reject any or all bids.

ALL VENDORS WHO CONDUCT BUSINESS WITH THE PENNSYLVANIA GAME COMMISSION MUST HAVE A VENDOR NUMBER ASSIGNED TO THEM IN ORDER TO RECEIVE PAYMENT FROM THE COMMONWEALTH.

Vendors may access the website [www.pasupplierportal.state.pa.us](http://www.pasupplierportal.state.pa.us) or phone (877) 435-7363 or (717) 346-2676 or email [ra-srmhelp@state.pa.us](mailto:ra-srmhelp@state.pa.us) for assistance to register as a new vendor or, if you are an existing vendor, to change a name or remit to address. This is a Dept of General services (DGS) website so you need to contact them directly if you have any problems with the website.

The unit price (acre) shall include all labor, equipment, tools, insurance and all items necessary for the completion of the project.

**VII. CONTRACT TERM:**

The contract term shall commence upon receipt of the performance bond and field work may begin **October 1, 2019** and terminate **November 22, 2019**. No contract extensions will be approved.

**VIII. PAYMENT TERMS:**

The contractor shall be paid at the unit price bid for ACTUAL feet treated as per the specifications of Attachment 1. The numbers of feet treated per the specifications will be measured by a PGC forestry representative.

# **ATTACHMENT 1 – TECHNICAL SPECIFICATIONS FOR ROAD CONSTRUCTION PROJECT ON SGL 080 SCHUYLKILL COUNTY**

## **1.1 -SCOPE**

This work involves the construction of a total of 4,589 feet of woods road in Pine Grove Township, Schuylkill County. On the road to construct, the contractor will be required to clear rocks and push trees to obtain a cleared and drivable 12' road running surface. Trees will be placed adjacent to but not in the road surface, side ditches or stream drainages. The road will need to be crowned and ditched with water turnouts to drain surface water from the road surface. The intended center line of the road is marked with orange paint and edges of the road corridor is marked with blue paint. All trees inside the road corridor must be cut and all sawtimber logs must be removed from site. Sawtimber logs are defined as logs larger than 10 inches on the small end. The contractor is permitted to create borrow sites along the road to obtain fill. All borrow sites must be graded and seeded upon completion of the project. Portions of the road surface can be created by using fill when needed. Borrow sites are to be used in addition to designated stone, not as a replacement. The section of road to improve will require regrading and the placement of stone.

### **Stone:**

A minimum of 500 tons of AASTHO # 3 stone is required. The section of the road from the start running south to the T intersection is required to be top dressed with stone. The remainder of the stone is to be used at culvert pipes and other sites as designated by the regional forester as construction progresses.

Receipts may be required to verify the amount of stone applied to the designated locations.

## **1.2 – PROCEDURE & TERMS**

1. The contractor is required to use a D - 5 or larger dozer with a six way blade or a bulldozer (953 or larger machine) with a bucket for this project. The contractor is required to push trees, push rocks and clear and shape the road surface. All water control structures must be installed by the contractor. A tract hoe may be used to clear and shape the road. A bulldozer must be used for final grading of the road surface. The road must have a 12' driving surface and have water control structures installed at designated locations. Drivable water bars/intercept dips will be used to drain the road surface. Erosion control will be obtained by placing water bars at the recommended spacing based on the slope of the site. The contractor is responsible for installation of the water bars as well as seeding of the disturbed ground.
2. The contractor will supply and install one smooth bore 24" X 20' black plastic culvert pipe, 7 smooth bore 30" X 20' black plastic culvert pipes, and one smooth bore 36" X 20' black plastic culvert pipe. The pipe must be installed with a backhoe and be covered with a minimum of 15" of AASHTO # 3 stone. The pipe must have head walls and side ditches for the drainage of water to the pipe and a tailrace for drainage out of the pipe.
3. Acceptable Treatment Period:  
October 1 to November 22, 2019.

4. Trees in the road corridor must be cut and all sawlogs must be removed from site. A logging subcontractor may be used but must be approved by the regional forester. Skidding is restricted to the road corridor unless approved by the regional forester. The log landing must be approved by the regional forester and be cleared and graded at completion.
5. Non-work days are all Saturdays in October and November.
6. Damage to any non-target trees or shrubs is not acceptable. Payment for damages will be determined if deemed necessary by the Regional Forester. The rate of damage will be \$25.00 per tree for damage caused by the neglect of the contractor.
7. Damage to existing infrastructure (roads, trails, food plots, etc) will be the repaired by the contractor
8. The contractor will remove all trash and garbage generated from the completion of this contract. This is to include all materials related to the support of felling tools and equipment, as well as items generated through personal use by the contractor's employees.
9. All equipment will be cleaned of soil and debris before being moved onto site to prevent spread of invasive species.
10. The Pennsylvania Game Commission will make a PA-1 call prior to the work on the road. The contractor must provide notice to the Regional Forester at least 96 hours (4 days) prior to start of the work. The call will be placed and the contractor will be notified when work may begin.
11. The contractor may work at times other than the schedule of the PGC forestry representative. Inspection of the project will occur during normal working hours.
12. Final inspection of the habitat project will be conducted by the Regional Forester. The contractor may be present at the final inspection. Upon successful completion of the required work, payment will be released to the contractor. At the same time the performance bond will be released to the contractor.

### **3.3 - MEASUREMENT AND PAYMENT**

A price per feet will be the unit of bidding and payment will be based on the amount of feet successfully treated. Evaluation of the success of the treatment will be based on the quality of construction as determined by the regional forester.

# The Pennsylvania Game Commission

## SGL #80 - Nestle Road Timbersale

### Scribner Rule (BDFT) - All Volumes are Estimates

Block All - 4 acres

Species	10"-12" DBH		14" DBH		16" DBH		18" DBH		20" DBH		22" DBH		24" DBH		26" DBH		28" DBH		30"+ DBH		Sawtimber Totals			Pulpwood	
	#TR	VOL	#TR	VOL	#TR	VOL	#TR	VOL	#TR	VOL	#TR	VOL	#TR	VOL	#TR	VOL	#TR	VOL	#TR	VOL	Total Trees	Total Volume	Avg Vol Per Tree	Trees	Tons
Yellow-poplar	6	235	8	874	13	2,163	9	2,230	2	650	7	2,995	5	2,770	8	5,190	4	2,818	7	6,524	69	26,450	383	14	6
N. Red Oak	6	226	8	600	12	1,913	6	1,231	3	918	2	615	0	0	0	0	0	0	0	0	37	5,503	149	17	9
Red Maple	4	177	7	465	3	287	1	143	1	247	0	0	0	0	0	0	0	0	0	0	16	1,319	82	164	48
American Beech	4	165	2	136	3	423	1	204	0	0	0	0	0	0	0	0	0	0	0	10	928	93	57	15	
Black Oak	1	33	2	148	1	103	1	227	0	0	0	0	0	0	0	0	0	0	0	5	511	102	5	1	
Sweet Birch	0	0	2	152	2	212	0	0	0	0	1	132	0	0	0	0	0	0	0	5	496	99	111	26	
Hickories	0	0	0	0	0	0	0	0	1	325	0	0	0	0	0	0	0	0	0	1	325	325	1	0	
White Oak	2	65	1	122	0	0	1	136	0	0	0	0	0	0	0	0	0	0	0	4	323	81	13	4	
Sassafras	2	62	1	45	2	159	0	0	0	0	0	0	0	0	0	0	0	0	0	5	266	53	25	8	
Eastern Hemlock	0	0	0	0	0	0	0	0	0	0	1	118	0	0	0	0	0	0	0	1	118	118	6	1	
Chestnut Oak	0	0	0	0	0	0	0	0	1	102	0	0	0	0	0	0	0	0	0	1	102	102	0	0	
Black Cherry	0	0	1	79	0	0	0	0	0	0	0	0	0	0	0	0	0	0	0	1	79	79	0	0	
Black Gum	0	0	0	0	1	61	0	0	0	0	0	0	0	0	0	0	0	0	0	1	61	61	37	6	
Scarlet Oak	1	50	0	0	0	0	0	0	0	0	0	0	0	0	0	0	0	0	0	1	50	50	1	0	
Sweet Birch - dead	0	0	1	49	0	0	0	0	0	0	0	0	0	0	0	0	0	0	0	1	49	49	1	0	
Chestnut Oak - dead	0	0	0	0	0	0	0	0	0	0	0	0	0	0	0	0	0	0	0	0	0	0	74	42	
N. Red Oak - dead	0	0	0	0	0	0	0	0	0	0	0	0	0	0	0	0	0	0	0	0	0	0	10	4	
White Oak - dead	0	0	0	0	0	0	0	0	0	0	0	0	0	0	0	0	0	0	0	0	0	0	8	3	
Red Maple - dead	0	0	0	0	0	0	0	0	0	0	0	0	0	0	0	0	0	0	0	0	0	0	5	2	
Black Oak - dead	0	0	0	0	0	0	0	0	0	0	0	0	0	0	0	0	0	0	0	0	0	0	2	0	
Hickories - dead	0	0	0	0	0	0	0	0	0	0	0	0	0	0	0	0	0	0	0	0	0	0	1	0	
Spruce	0	0	0	0	0	0	0	0	0	0	0	0	0	0	0	0	0	0	0	0	0	0	1	0	
<b>Total</b>	<b>26</b>	<b>1,013</b>	<b>33</b>	<b>2,671</b>	<b>37</b>	<b>5,321</b>	<b>19</b>	<b>4,171</b>	<b>8</b>	<b>2,241</b>	<b>11</b>	<b>3,859</b>	<b>5</b>	<b>2,770</b>	<b>8</b>	<b>5,190</b>	<b>4</b>	<b>2,818</b>	<b>7</b>	<b>6,524</b>	<b>158</b>	<b>36,579</b>	<b>232</b>	<b>553</b>	<b>178</b>







PGC ROAD ENTRANCE  
TOUR MEETS HERE  
40.516443, -76.418420

SWOPES VALLEY ROAD

**NESTLE ROAD CONSTRUCTION PROJECT**  
STATE GAME LANDS 080  
SCHUYLKILL COUNTY  
PINE GROVE TOWNSHIP  
4,489 FEET





**Pipe Diameter (Inches)**

-  24
-  30
-  36

 Road to Build - 4,589 feet

**PGC\_Roads**

-  PGC\_Roads
-  Parking\_Area

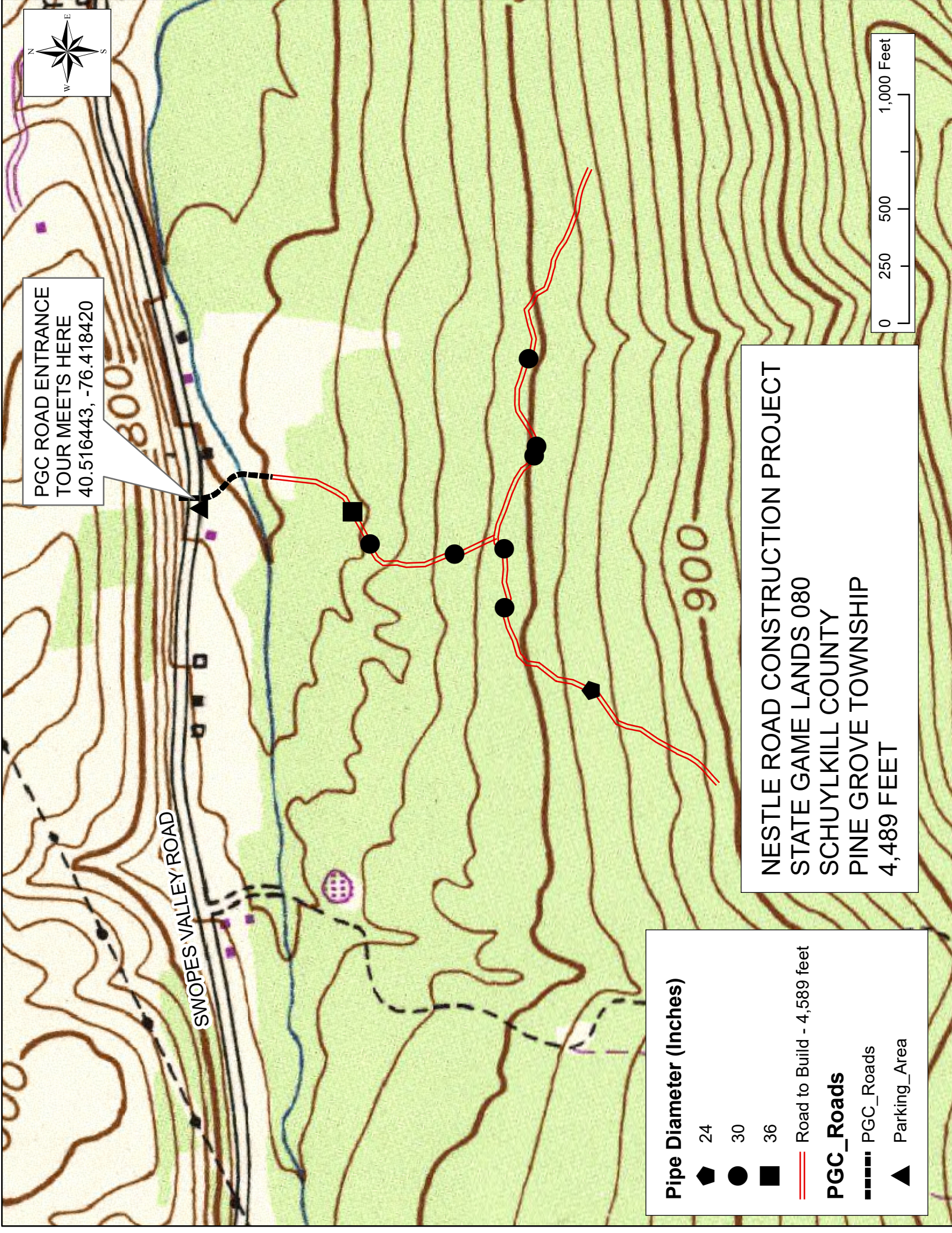



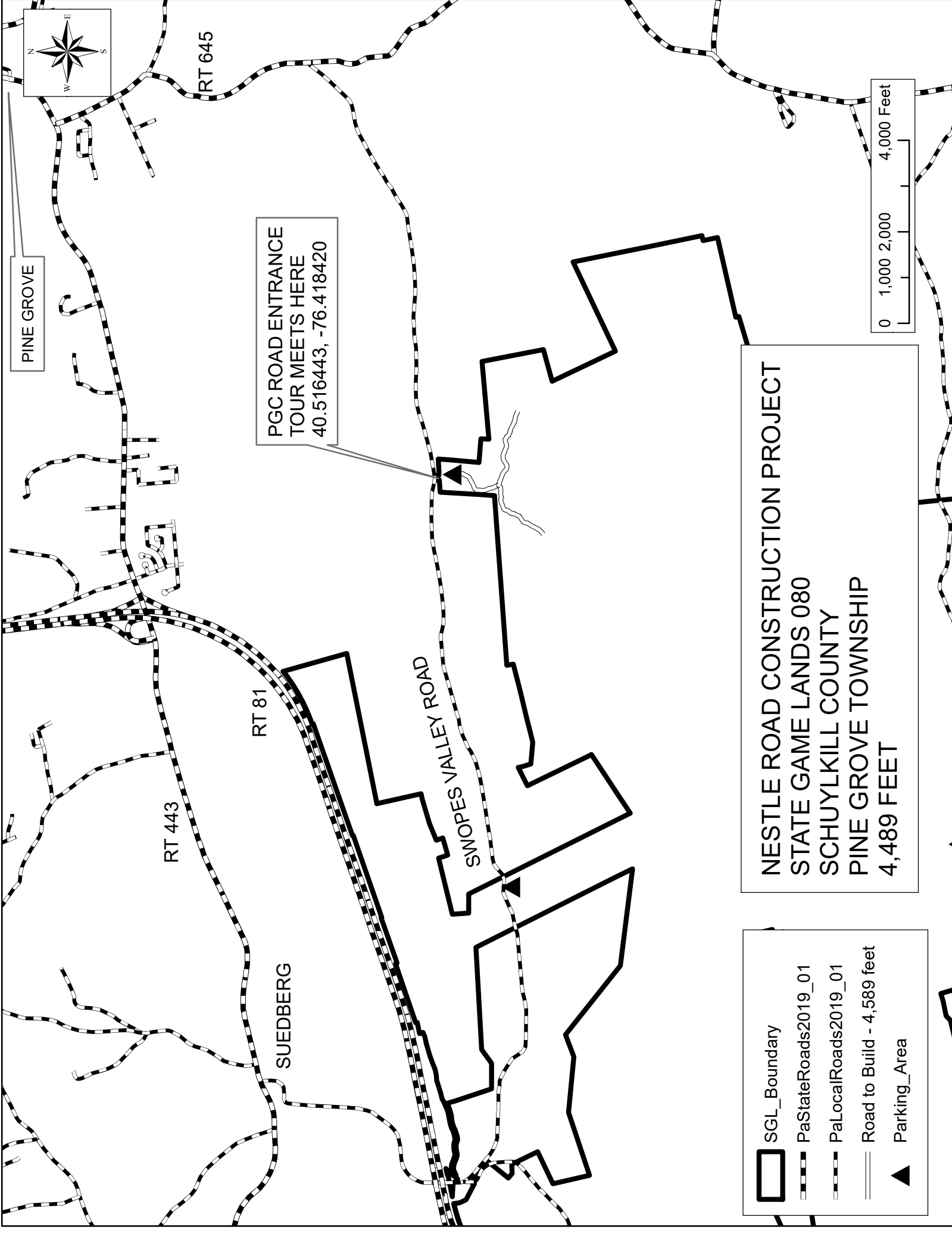

PINE GROVE

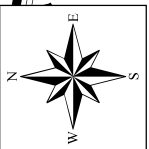

RT 645

PGC ROAD ENTRANCE  
TOUR MEETS HERE  
40.516443, -76.418420





RT 443

RT 81

SUEDBERG

SNOPES VALLEY ROAD

**NESTLE ROAD CONSTRUCTION PROJECT**  
**STATE GAME LANDS 080**  
**SCHUYLKILL COUNTY**  
**PINE GROVE TOWNSHIP**  
**4,489 FEET**

-  SGL\_Boundary
-  PaStateRoads2019\_01
-  PaLocalRoads2019\_01
-  Road to Build - 4,589 feet
-  Parking\_Area

