

Dock Live Load of 62.5 lbs/sqft
Low Profile Dock Live Load 30 lbs/sqft

MADE IN
USA

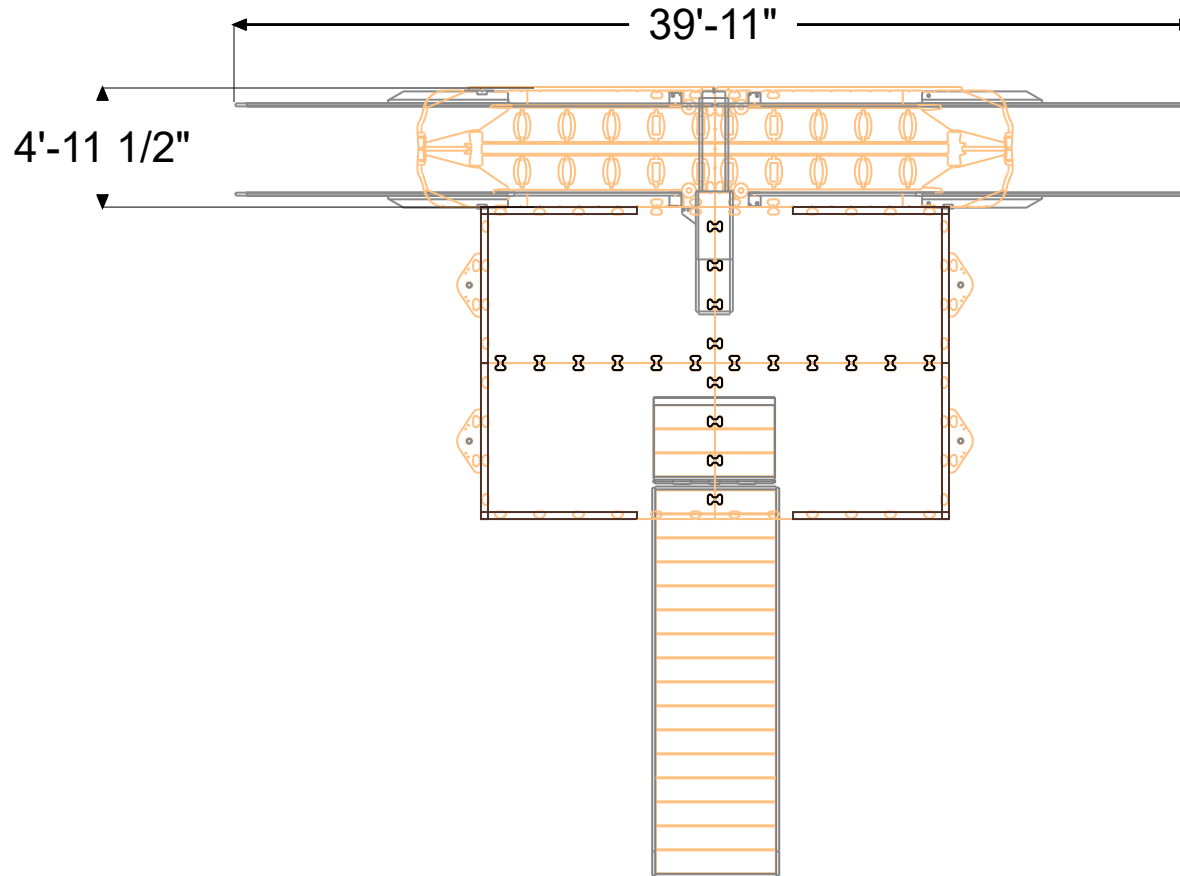

Project Name:

Typical PT ADA Launch
Anywhere, NY

Distributor Name:

Joel Kanick
Greater Lakes EZ-Dock
(716) 773-7063

Drawn by: Joel Kanick

Date: 3/29/2017

DWG Name: R0401_42823426669

EZ Dock, Inc

878 East Highway 60

Monett, Missouri 65708

Phone: 1 (800) 654-8168

Fax: (417) 235-2232

General Notes:

1. This drawing does not reflect anchoring. Once sufficient information & completed Proposal Request Form concerning water and bottom conditions is received, anchoring may be detailed.
2. Note: It is the dock owner/operator's responsibility to ascertain and comply with all applicable Federal, State, and local laws, ordinances and regulations, as well as all inspection, permitting and licensing requirements pertaining to the installation, application and use of EZ Dock products on the owner/operator's premises. EZ Dock, Inc. assumes no duty or responsibility with respect to the legality or compliancy of the owner/operator's chosen installation, application or use of EZ Dock products.
3. Reference EZ Dock Owner Manual for additional details.

Greater Lakes EZ-Dock



Proudly Serving Central & Western NY, Western PA, and Northern Ohio

NOTICE! Read EZ Dock Limited Warranty carefully. Among other things, EZ Dock does not warrant damages, failures or defects caused by unauthorized modification of EZ Dock Product, and/or unauthorized attachment to/of EZ Dock Product.

Dock Live Load of 62.5 lbs/sqft
Low Profile Dock Live Load 30 lbs/sqft

MADE IN
USA

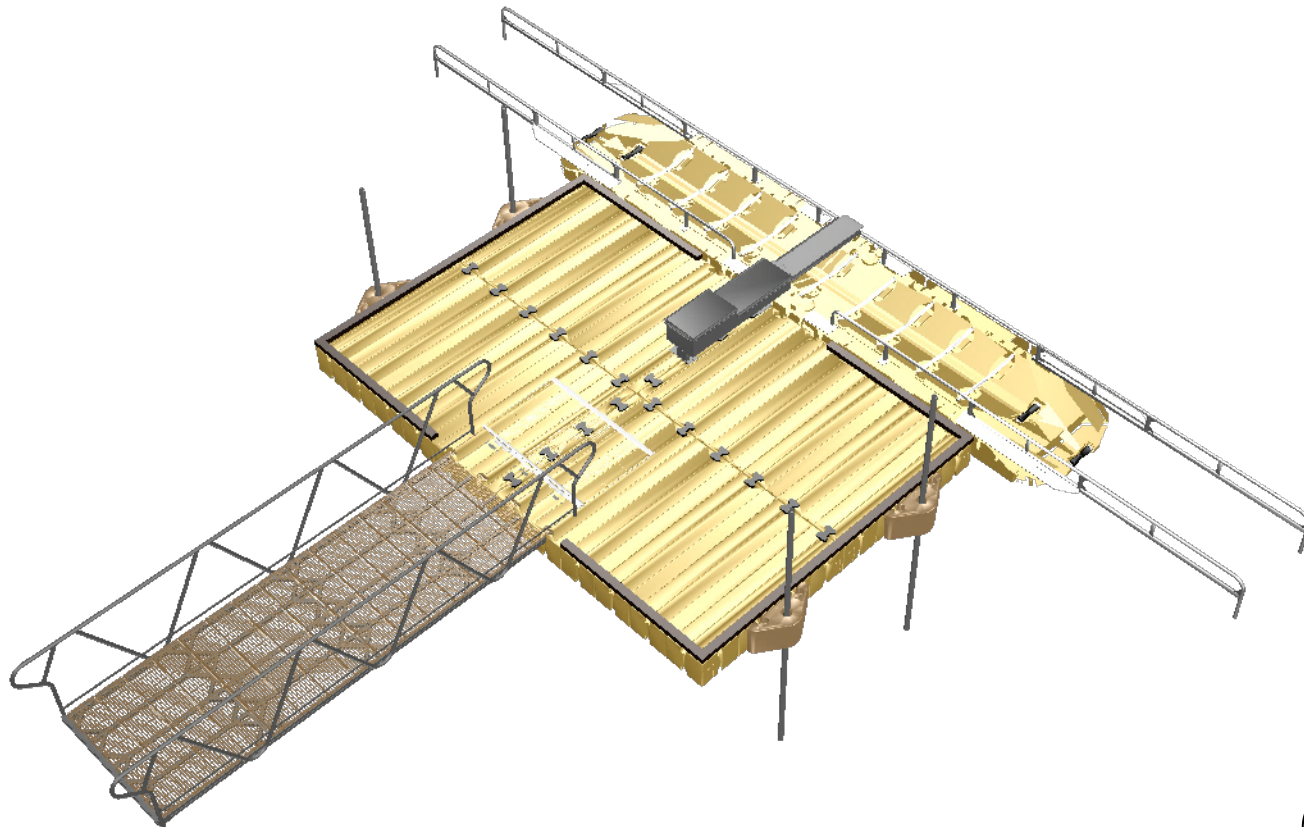

Project Name:

Typical PT ADA Launch
Anywhere, NY

Distributor Name:

Joel Kanick
Greater Lakes EZ-Dock
(716) 773-7063

Drawn by: Joel Kanick

Date: 9/11/2017

DWG Name: R0401_42823426669

EZ Dock, Inc

878 East Highway 60

Monett, Missouri 65708

Phone: 1 (800) 654-8168

Fax: (417) 235-2232

General Notes:

1. This drawing does not reflect anchoring. Once sufficient information & completed Proposal Request Form concerning water and bottom conditions is received, anchoring may be detailed.
2. Note: It is the dock owner/operator's responsibility to ascertain and comply with all applicable Federal, State, and local laws, ordinances and regulations, as well as all inspection, permitting and licensing requirements pertaining to the installation, application and use of EZ Dock products on the owner/operator's premises. EZ Dock, Inc. assumes no duty or responsibility with respect to the legality or compliancy of the owner/operator's chosen installation, application or use of EZ Dock products.
3. Reference EZ Dock Owner Manual for additional details.

Greater Lakes EZ-Dock



Proudly Serving Central & Western NY, Western PA, and Northern Ohio

NOTICE! Read EZ Dock Limited Warranty carefully. Among other things, EZ Dock does not warrant damages, failures or defects caused by unauthorized modification of EZ Dock Product, and/or unauthorized attachment to/of EZ Dock Product.